

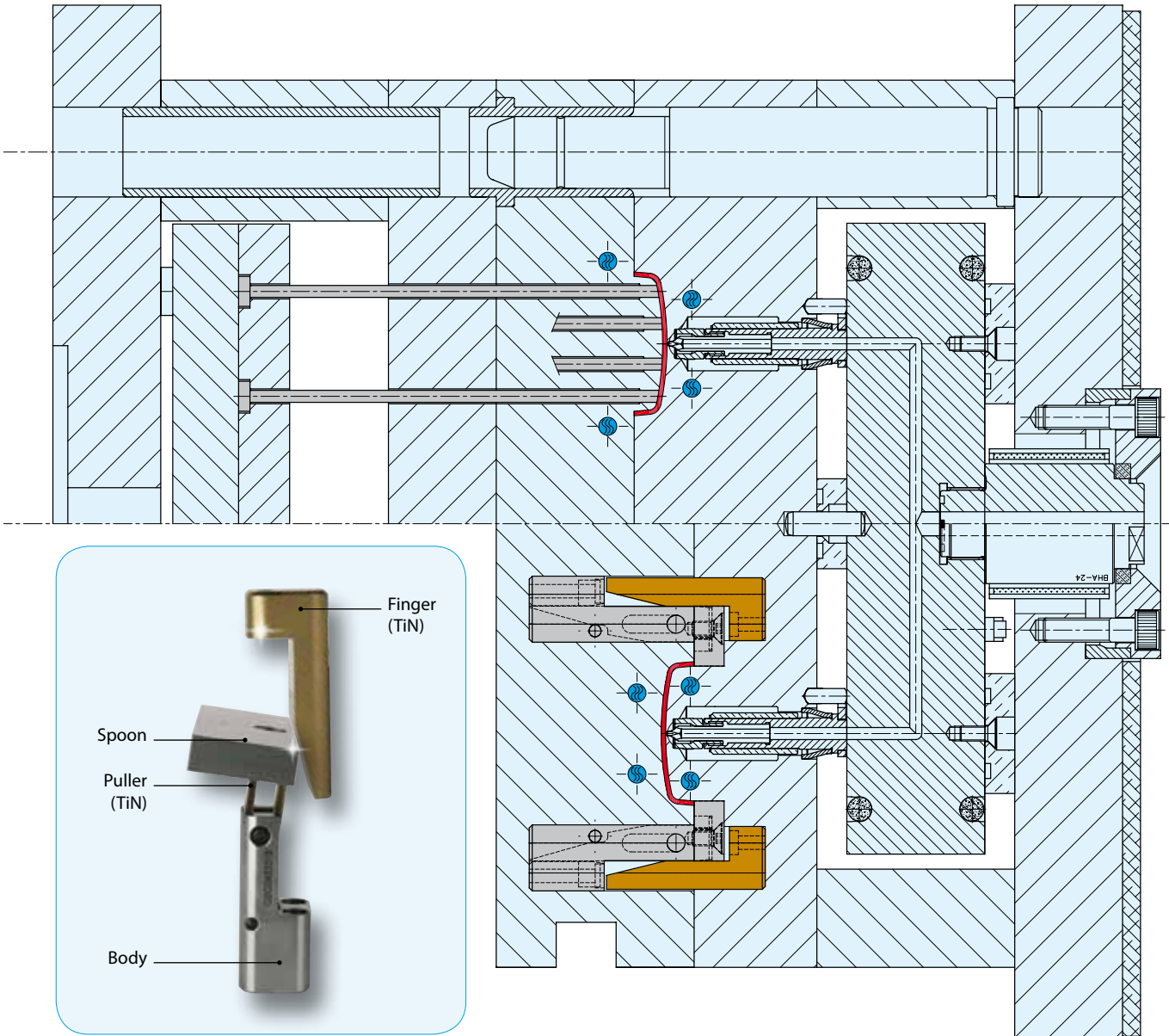

Advantages

- no ejector plates nor risers
- mold height is reduced
- no wasted cycle time with ejector stroke
- cooling can be optimised
- reduced cycle time
- no ejector marks on molded part
- reduced friction so less maintenance
- simplifies mold construction: cheaper / faster
- can be used on fixed or moving half
- no restrictions on fixed or moving half
- no restrictions on injection point
- multiple cavities can be served with one unit
- further optimisation by implementing in Stack molds
- further optimisation by implementing in Tandem molds
- standardised off the shelf availability
- can be used for every injection process, plastics, die casting, rubber, ...



⊕ CAD reference point

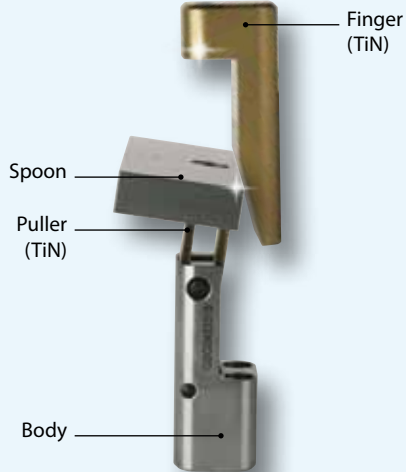

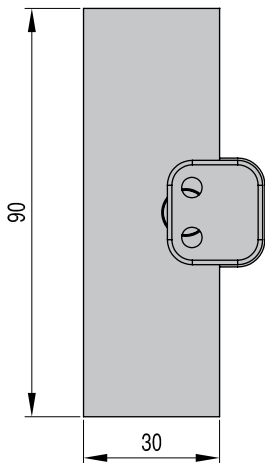
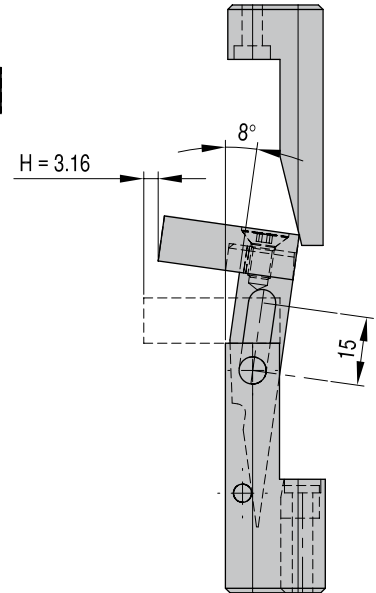
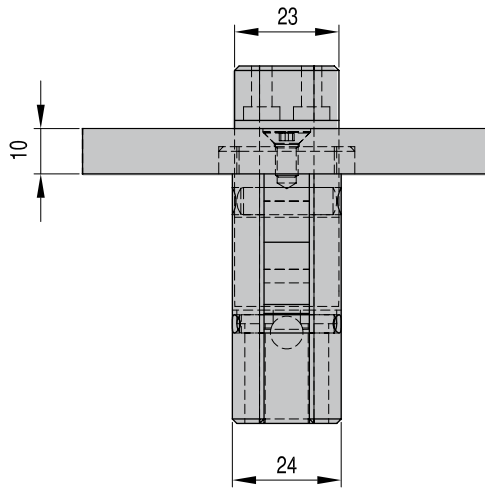
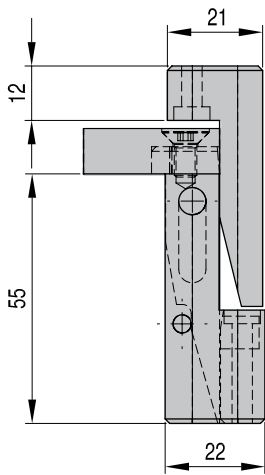

Spoon to be adjusted by toolmaker
to fit mold and product contour.
Standard material type 1.2312,
other steel qualities available upon request

CAD reference point



	REF
QS 24 22 015	



Quick Strip 24 x 30 mm - stroke 15 mm - 15°

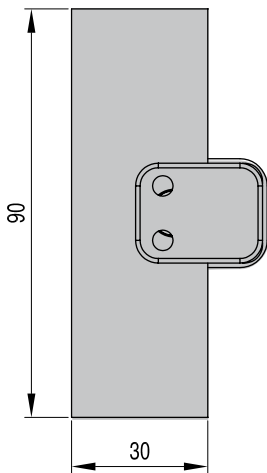
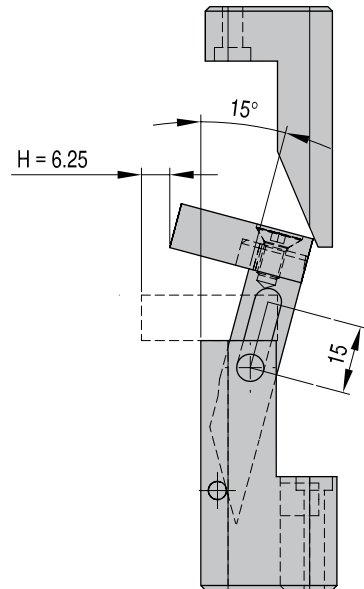
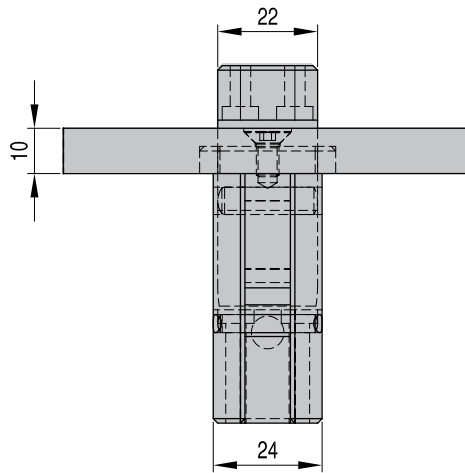
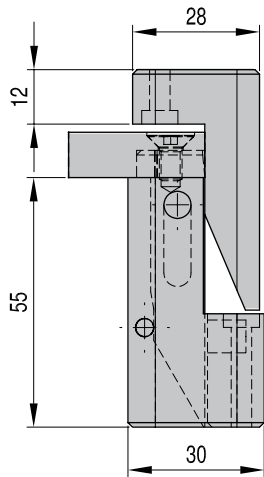

Spoon to be adjusted by toolmaker to fit mold and product contour.
Standard material type 1.2312,
other steel qualities available upon request

REF

QS 24 30 015

CAD reference point



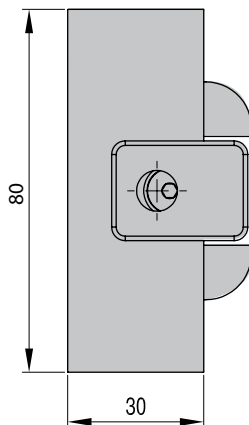
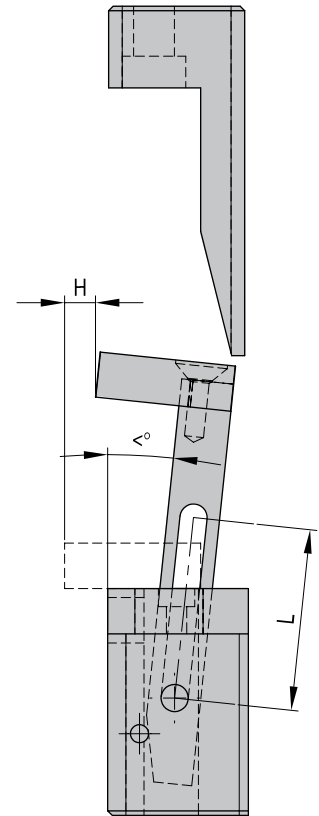
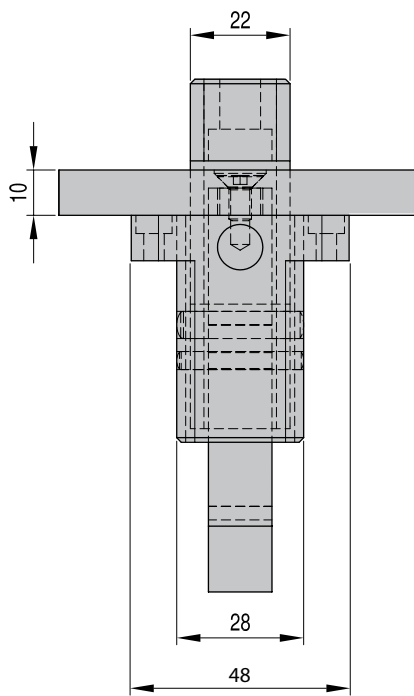
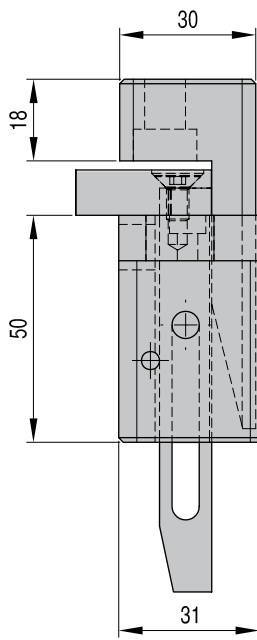

Spoon to be adjusted by toolmaker to fit mold and product contour.
Standard material type 1.2312,
other steel qualities available upon request

CAD reference point



REF	Stroke
QS 28 31 040	40
QS 28 31 060	60
QS 28 31 080	80
QS 28 31 100	100