

Shaft Fine Ground and Nitrided  
Max. Working Temperature of 650°C

Shaft Surface Hardness: Min 950 HV 0.3  
Core Hardness: 40-45 HRC  
Head Hardness: 45±5 HRC

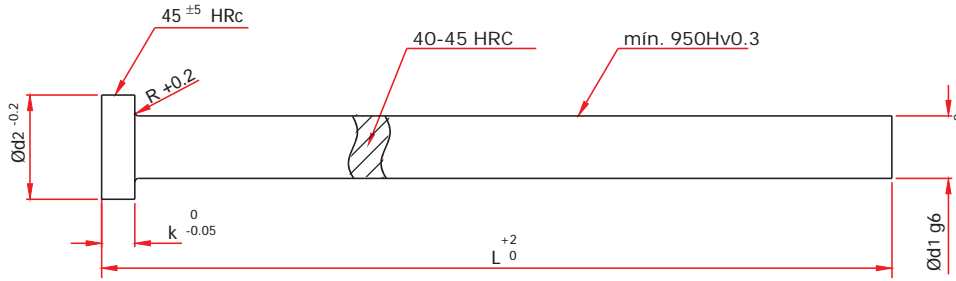

d1 (g6)	d2 -0.2	K -0.05	r	L (+2)											
				100	125	160	200	250	315	400	500	630	800	1000	
1.5	3	1.5	0.2	x	x	x	x								
2	4	2	0.2	x	x	x	x	x	x						
2.2	4	2	0.2	x	x	x	x	x	x						
2.5	5	2	0.3	x	x	x	x	x	x						
2.7	5	2	0.3	x	x	x	x	x	x						
3	6	3	0.3	x	x	x	x	x	x	x	x				
3.2	6	3	0.3	x	x	x	x	x	x	x					
3.5	7	3	0.3	x	x	x	x	x	x	x					
3.7	7	3	0.3	x	x	x	x	x	x	x					
4	8	3	0.3	x	x	x	x	x	x	x	x	x			
4.2	8	3	0.3	x	x	x	x	x	x	x					
4.5	8	3	0.3	x	x	x	x	x	x	x					
5	10	3	0.3	x	x	x	x	x	x	x	x	x	x	x	x
5.2	10	3	0.3	x	x	x	x	x	x	x	x				
5.5	10	3	0.3	x	x	x	x	x	x	x	x				
6	12	5	0.5	x	x	x	x	x	x	x	x	x	x	x	x
6.2	12	5	0.5	x	x	x	x	x	x	x	x				
6.5	12	5	0.5	x	x	x	x	x	x	x	x				
7	12	5	0.5	x	x	x	x	x	x	x	x				
8	14	5	0.5	x	x	x	x	x	x	x	x	x	x	x	x
8.2	14	5	0.5	x	x	x	x	x	x	x	x	x			
8.5	14	5	0.5	x	x	x	x	x	x	x	x	x			
9	14	5	0.5	x	x	x	x	x	x	x	x	x			
10	16	5	0.5	x	x	x	x	x	x	x	x	x	x	x	x
10.2	16	5	0.5	x	x	x	x	x	x	x	x	x			
10.5	16	5	0.5	x	x	x	x	x	x	x	x	x			
11	16	5	0.5	x	x	x	x	x	x	x	x	x			
12	20	7	0.8	x	x	x	x	x	x	x	x	x	x	x	x
12.2	20	7	0.8	x	x	x	x	x	x	x	x	x			
12.5	20	7	0.8	x	x	x	x	x	x	x	x	x			
14	22	7	0.8	x	x	x	x	x	x	x	x	x	x	x	x
16	22	7	0.8	x	x	x	x	x	x	x	x	x	x	x	x
18	24	7	0.8	x	x	x	x	x	x	x	x	x	x	x	x
20	26	8	1	x	x	x	x	x	x	x	x	x	x	x	x
25	32	10	1					x	x	x	x	x	x	x	x
32	40	10	1					x	x	x	x	x	x	x	x
40	50	10	1					x	x	x	x	x	x	x	x

Order format : A / d1 x L  
Example : A / 1.5 x 160