

Through Hardened and Fine Ground
Max. Working Temperature of 220°C

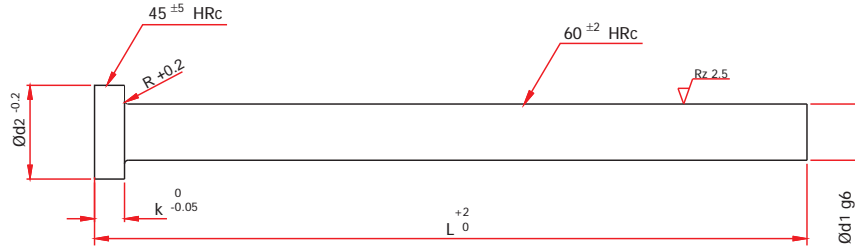

d1 (g6)	d2 -0.2	K -0.05	r	L (+2)							
				100	125	160	200	250	315	400	500
1.5	3	1.5	0.2	x	x	x	x				
2	4	2	0.2	x	x	x	x	x	x		
2.2	4	2	0.2	x	x	x	x	x	x		
2.5	5	2	0.3	x	x	x	x	x	x		
2.7	5	2	0.3	x	x	x	x	x	x		
3	6	3	0.3	x	x	x	x	x	x	x	x
3.2	6	3	0.3	x	x	x	x	x	x	x	
3.5	7	3	0.3	x	x	x	x	x	x	x	
3.7	7	3	0.3	x	x	x	x	x	x	x	
4	8	3	0.3	x	x	x	x	x	x	x	x
4.2	8	3	0.3	x	x	x	x	x	x	x	
4.5	8	3	0.3	x	x	x	x	x	x	x	
5	10	3	0.3	x	x	x	x	x	x	x	x
5.2	10	3	0.3	x	x	x	x	x	x	x	
5.5	10	3	0.3	x	x	x	x	x	x	x	
6	12	5	0.5	x	x	x	x	x	x	x	x
6.2	12	5	0.5	x	x	x	x	x	x	x	
6.5	12	5	0.5	x	x	x	x	x	x	x	
7	12	5	0.5	x	x	x	x	x	x	x	
8	14	5	0.5	x	x	x	x	x	x	x	x
8.2	14	5	0.5	x	x	x	x	x	x	x	
8.5	14	5	0.5	x	x	x	x	x	x	x	
9	14	5	0.5	x	x	x	x	x	x	x	
10	16	5	0.5	x	x	x	x	x	x	x	x
10.2	16	5	0.5	x	x	x	x	x	x	x	
10.5	16	5	0.5	x	x	x	x	x	x	x	
11	16	5	0.8	x	x	x	x	x	x	x	
12	20	7	0.8	x	x	x	x	x	x	x	x
12.2	20	7	0.8	x	x	x	x	x	x	x	
12.5	20	7	0.8	x	x	x	x	x	x	x	
14	22	7	0.8	x	x	x	x	x	x	x	x
16	22	7	0.8	x	x	x	x	x	x	x	x
18	24	7	0.8	x	x	x	x	x	x	x	x
20	26	8	1	x	x	x	x	x	x	x	x
25	32	10	1					x			

Order format: AH / d1 x L

Example: AH / 6.5 x 315