

Gib Coupling retains the Core Blade and supports vertical movement.

Core Blades are manufactured from A-10 material, ready for molding detail

Lifter Support Guides are available for when support plate alignment is required.

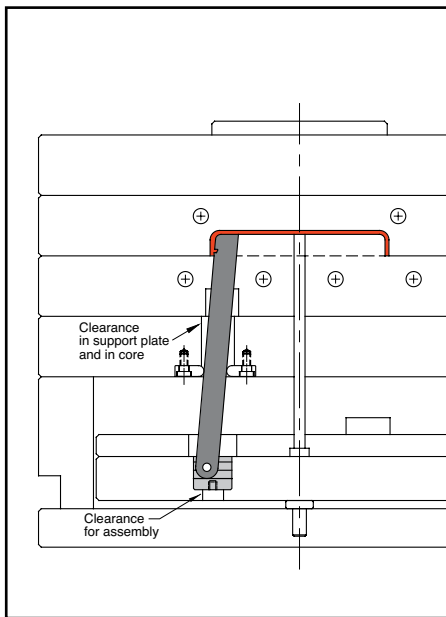

**Mold Closed**

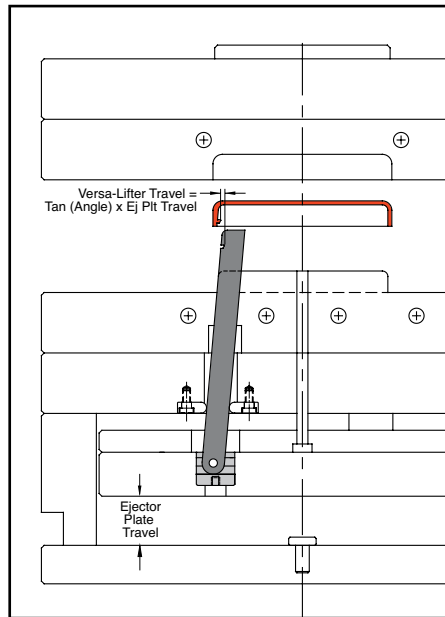

**Mold Open**

### Design Guidelines:

1. Typical angles are 5-15°, but users have reported success at larger angles for unique applications with greater bearing, such as cavity side core pulls. Contact Engineering for an application review.
2. Guided Ejection is required, and the Lifter Support Guides are recommended in all applications.
3. Recommended total clearance is .001"-.0015" (.025-.038mm) where permissible.
4. Core insert material should be at least 10 HRC different than the Core Blade material.
5. Locking angles can be designed to accept molding pressure.
6. Non-standard sizes or mold-ready Core Blades can be provided by sending a request to [tech@procomps.com](mailto:tech@procomps.com).

### Design Options:

For positive return, a locking angle can be designed into the Core Blade as shown at right.

In addition, if space is limited at parting line, the Core Blade can be stepped.

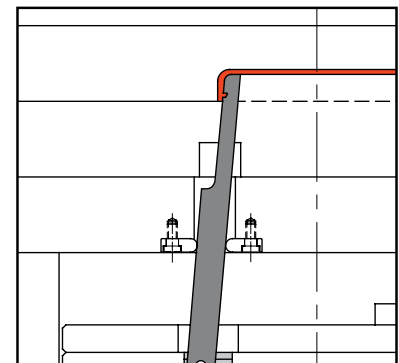
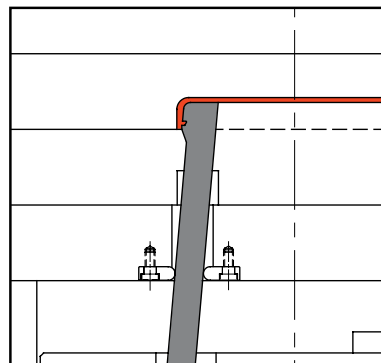

## GIB COUPLINGS

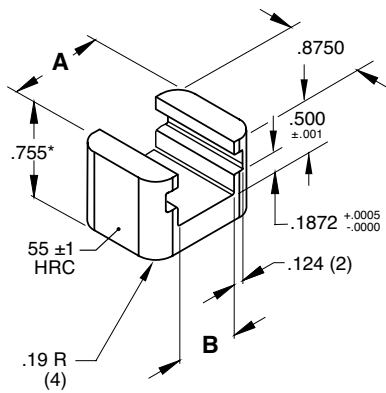

**M** S-7 **S** 54-56 HRC

CATALOG NUMBER	A Central	B +.001 -.000	Compatible Core Blade Widths (W)	Omni Catalog Number
UGV68	.6860	.190	.1875 & .4375	LG-10
UGV87	.8735	.377	.6250	LG-20
UGV112	1.1235	.627	.8750	LG-30
UGV137	1.3735	.877	1.1250	LG-40

\* .005" stock is included on the bottom for fitting.

## LIFTER SUPPORT GUIDES

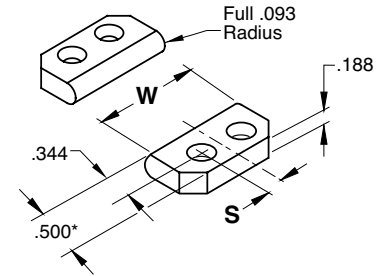

**M** S-7 **S** 54-56 HRC

CATALOG NUMBER	W	S	Omni Catalog Number
SGV43	.436	On Center	SG-10
SGV62	.624	On Center	SG-20
SGV87	.874	.187	SG-30
SGV112	1.124	.312	SG-40

Notes:

- \*Includes .005" fit stock on flat side.
- The Lifter Support Guides are sold in pairs.
- Four (4) #6-32 LHCS are included.

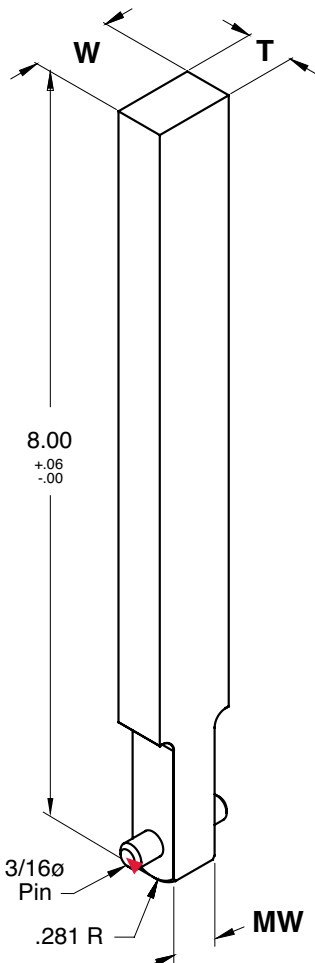

**M** A-10 **S** 58-60 HRC

T +.0000 -.0003	CATALOG NUMBER	W +.0000 -.0003	MW +.000 -.001
.5000	CBV50X18L8	.1875	.188
	CBV50X43L8	.4375	.188
	CBV50X62L8	.6250	.375
	CBV50X87L8	.8750	.625
	CBV50X112L8	1.1250	.875

Pre-engineered pin is included.

## VERSA-LIFTER® CORE BLADES

### Assembly Guidelines:

1. Assembly length (4") cap screw (#10-32) is included with each lifter.
2. Install the assembly screw in the Gib Coupling as shown.
3. Connect the lifter pin and pull unit into pocket in ejector plate, removing the screw afterwards.

