

STACKIT STACK MOLD SYSTEM

Introducing a system for efficiently designing, building, and maintaining stack molds. The product range addresses Center Section Positioning, Center Section Support, and Ejector Actuation. Available as standard components with center support systems made to order.

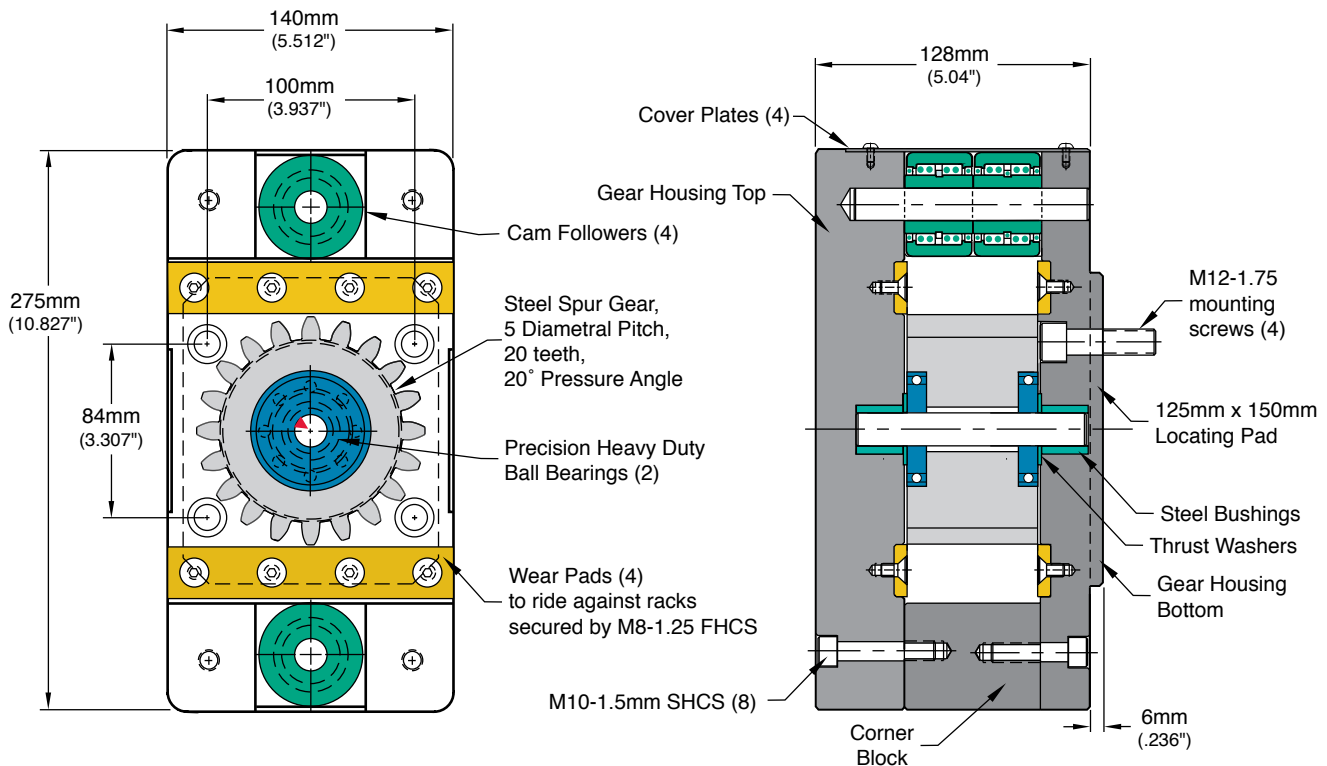
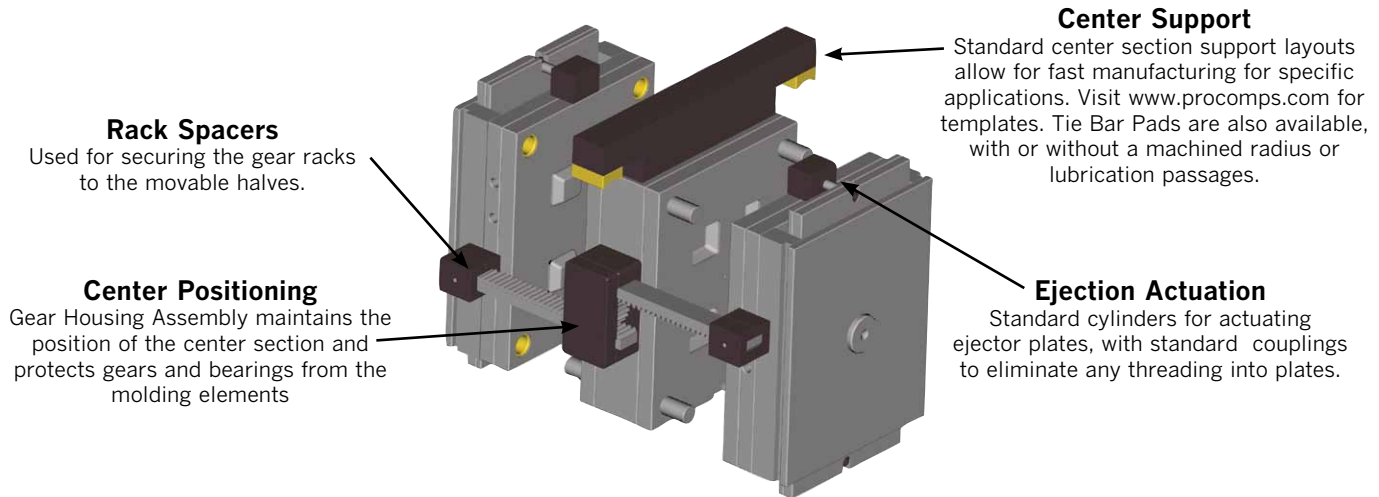

CATALOG NUMBER	DESCRIPTION
SK-GHA-250	Gear Housing Assembly

Replacement parts are available. Refer to the price list for catalog numbers and pricing, and contact Customer Service for availability.

STACKIT RACK SPACER

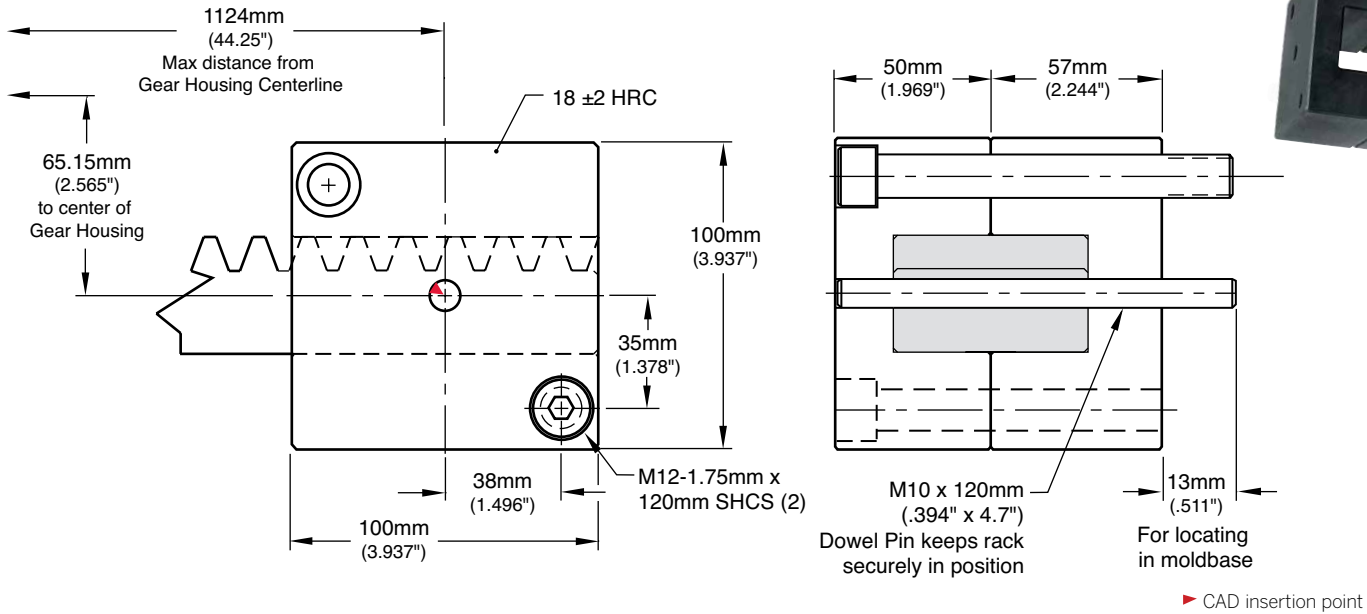

M A-36 **H** Pre-Hard **S** Black Oxide

CATALOG NUMBER	DESCRIPTION
SK-RSA-250	Rack Spacer Assembly

Screws and locating dowel included.

STACKIT® RACK

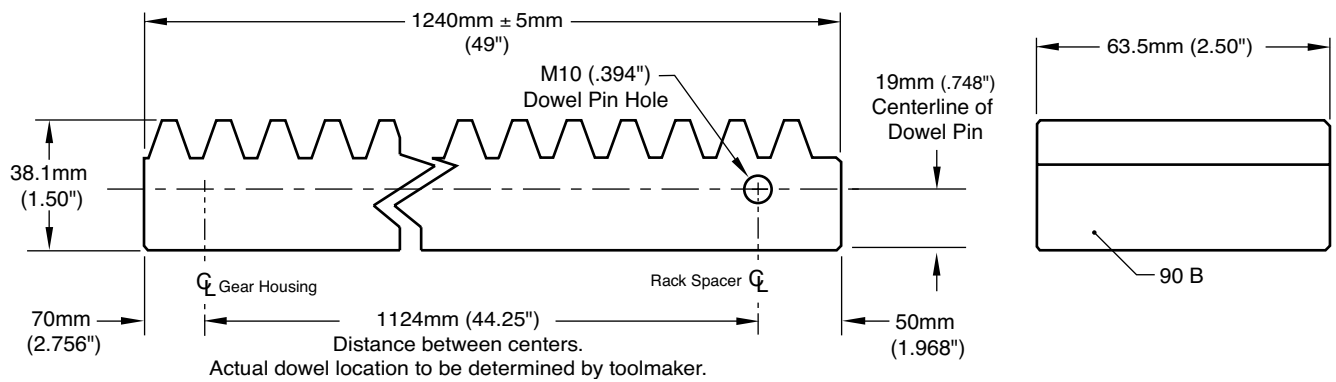

M AISI 1018

CATALOG NUMBER	DESCRIPTION
SK-RC-250	Rack (Sold Individually)

STACKIT® TIE BAR PADS



SK-TBP-35

Tie Bar Pad Blanks

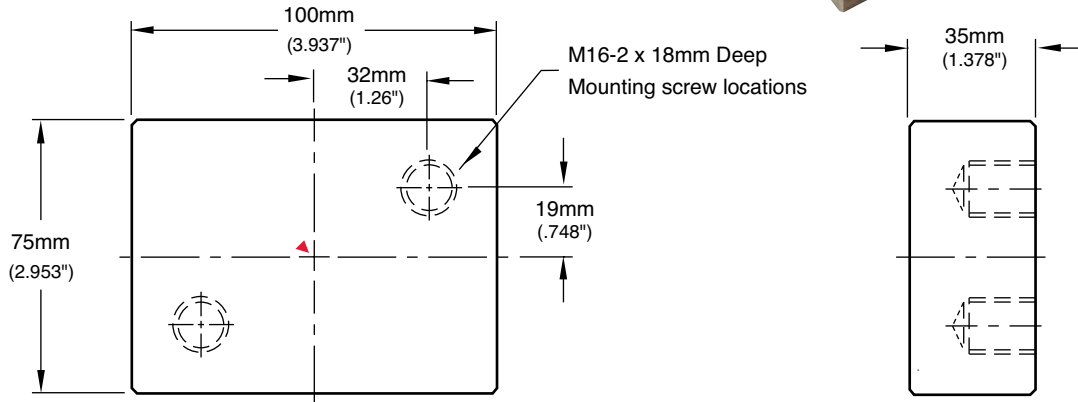

SK-TBP-R

Tie Bar Pad with finished radius. Please specify "-R" when ordering

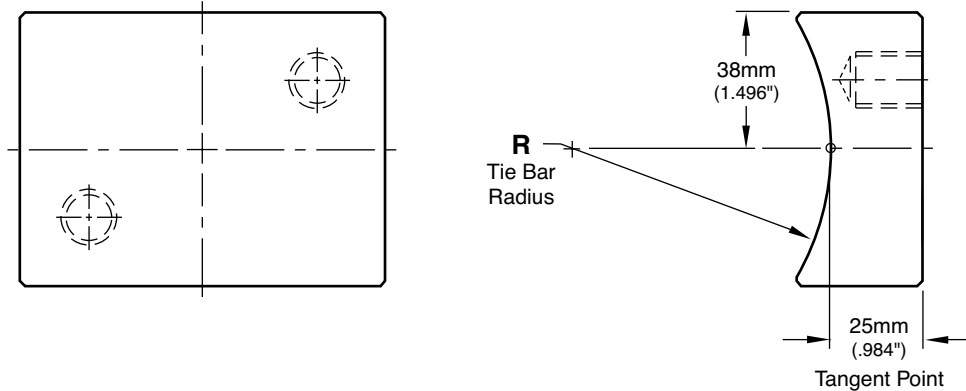

SK-TBP-RG

Tie Bar Pad with finished radius, grease grooves, and zerk fitting. Please specify "-RG" when ordering

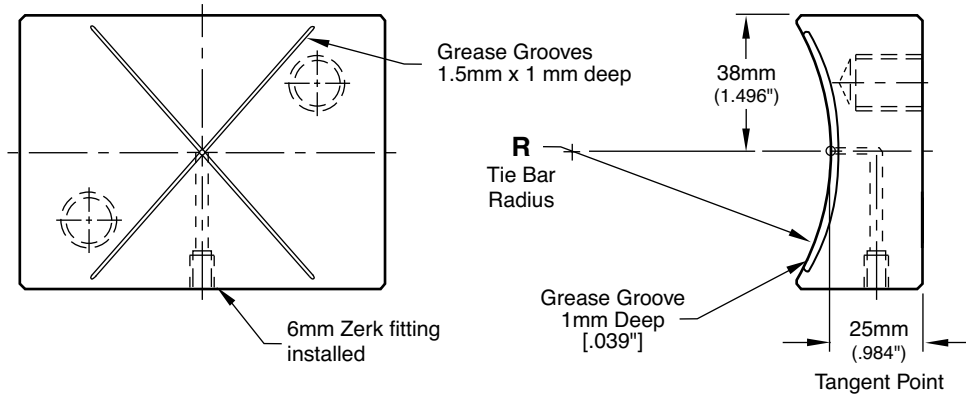

M CA954 Solid Bronze

▶ CAD insertion point

CATALOG NUMBER	DESCRIPTION
SK-TBP-35	Tie Bar Pad Blanks (No Radius)
SK-TBP-R	Tie Bar Pads with machined radius
SK-TBP-RG	Tie Bar Pads with machined radius, grease grooves and zerk fitting

Sold individually.

STACKIT EJECTION ACTUATION

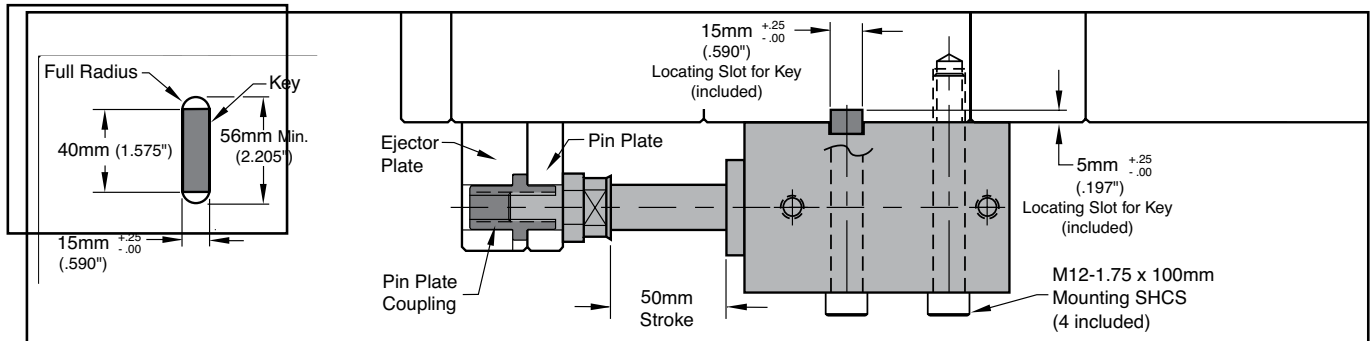

CYLINDERS

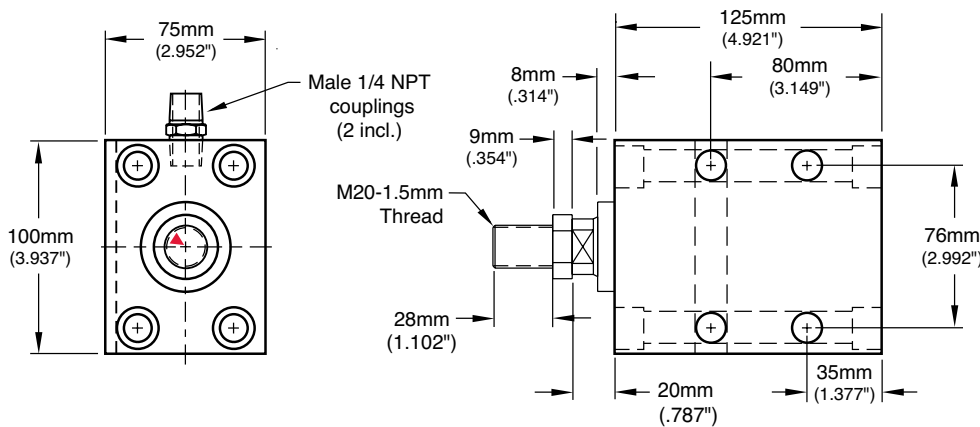

Specifications:

- 50mm (2'') Stroke
- Rated up to 3200 psi
- Temperature: 220° F (100° C) max
- Includes (2) NPT couplings and Locating Key

▶ CAD insertion point

CATALOG NUMBER	DESCRIPTION
SK-CYL-50	50 mm Block Cylinder

PIN PLATE COUPLINGS

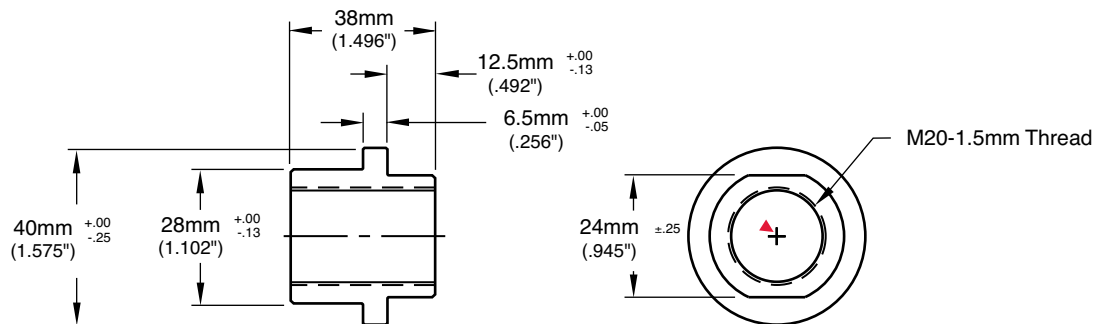

M AISI 4140 S Black Oxide ▶ CAD insertion point

CATALOG NUMBER	DESCRIPTION
SK-PPC-20	M20-1.55 mm Pin Plate Coupling

STACKIT® CENTER SUPPORT SYSTEMS

Center Supports augment the pin and bushing engagement between the center section and movable mold halves. Manufactured for specific applications out of AISI 4140, Progressive center sections utilize standard layouts, templates, and components.

Style 1
Top Reach Support

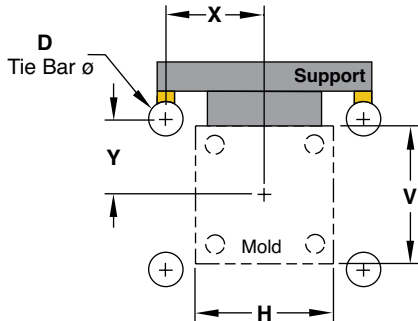

Style 2
Bottom Reach Support

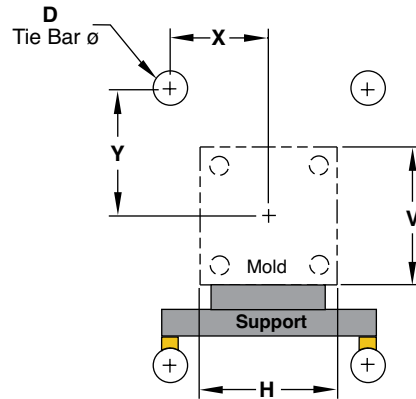

Style 3
Side Support (Top)

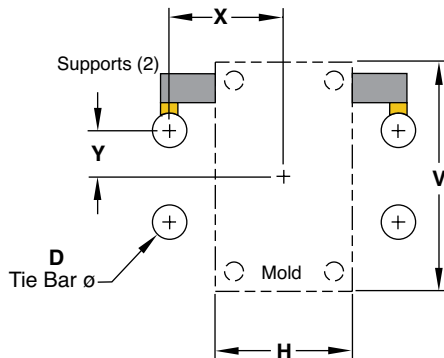

Style 4
Side Support (Bottom)

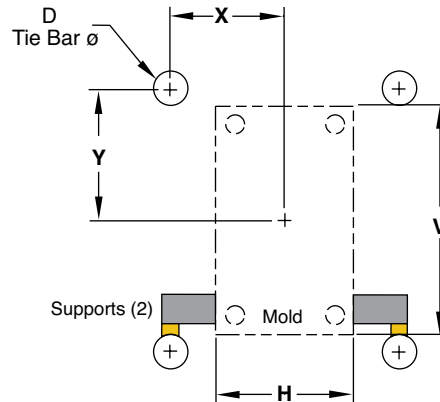

Style 5
Way Support

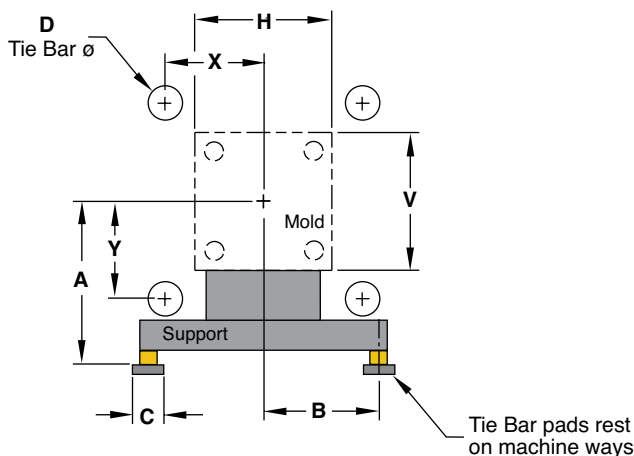

To obtain a quote:

1. Select the style of center support system based on the general press layout and preference.
2. Determine the variables based on the graphics for the corresponding support required.
3. Send the information in email to Tech@progressive.com and an Applications Engineer will provide pricing and turnaround for the quantity required.