

Friction Pullers can be used to uniformly draw floating plates and inserts. Designed to replace shoulder bolts, the Friction Pullers initiate movement and utilize friction at a particular setting to release the plate when the travel limits are reached.

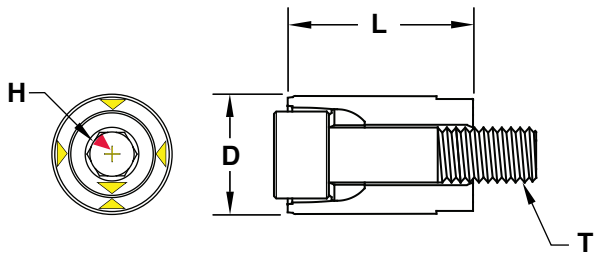

Order Code	D	L	T	H Hex	HD Hole Depth	Maximum Force (Each)
FP-10	10	17	M5-0.80	3	20	32.5 Kg
FP-13	13	20	M6-1.00	4	23	62.5 Kg
FP-16	16	25	M8-1.25	5	30	150.0 Kg
FP-20	20	28	M10-1.50	6	32	212.5 Kg

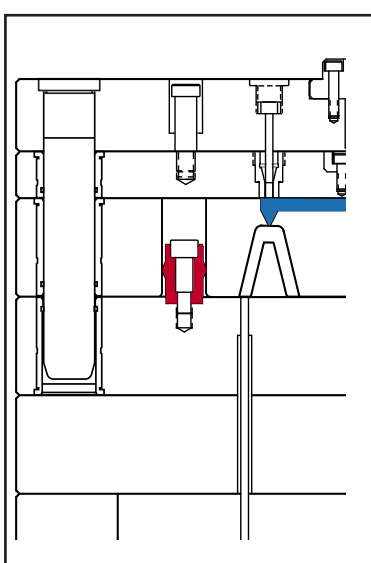

Mold Closed

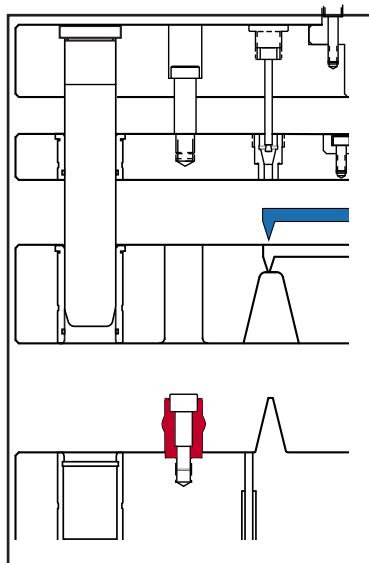

Mold Open

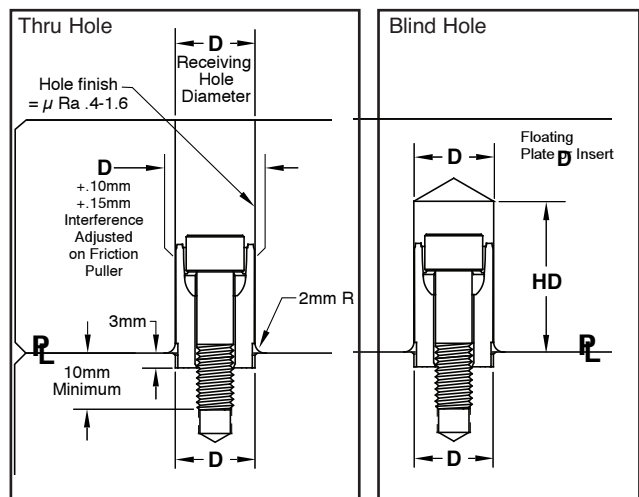

Recommended interference fit is .1 to .15mm larger than the receiving hole. To adjust the Friction Puller, rotate the screw clockwise and measure bulge to achieve the proper fit. Further adjustments can be performed with 1/4 turn increments, lining up the reference arrows on the fastener to the resin.

