

- \* **Small installation dimensions**
- \* **Built lock in cylinder**
- \* **Stroke limitation**
- \* **Return of ejector pin plates**
- \* **Stroke delay possible**
- \* **Control of ejector pin plates**

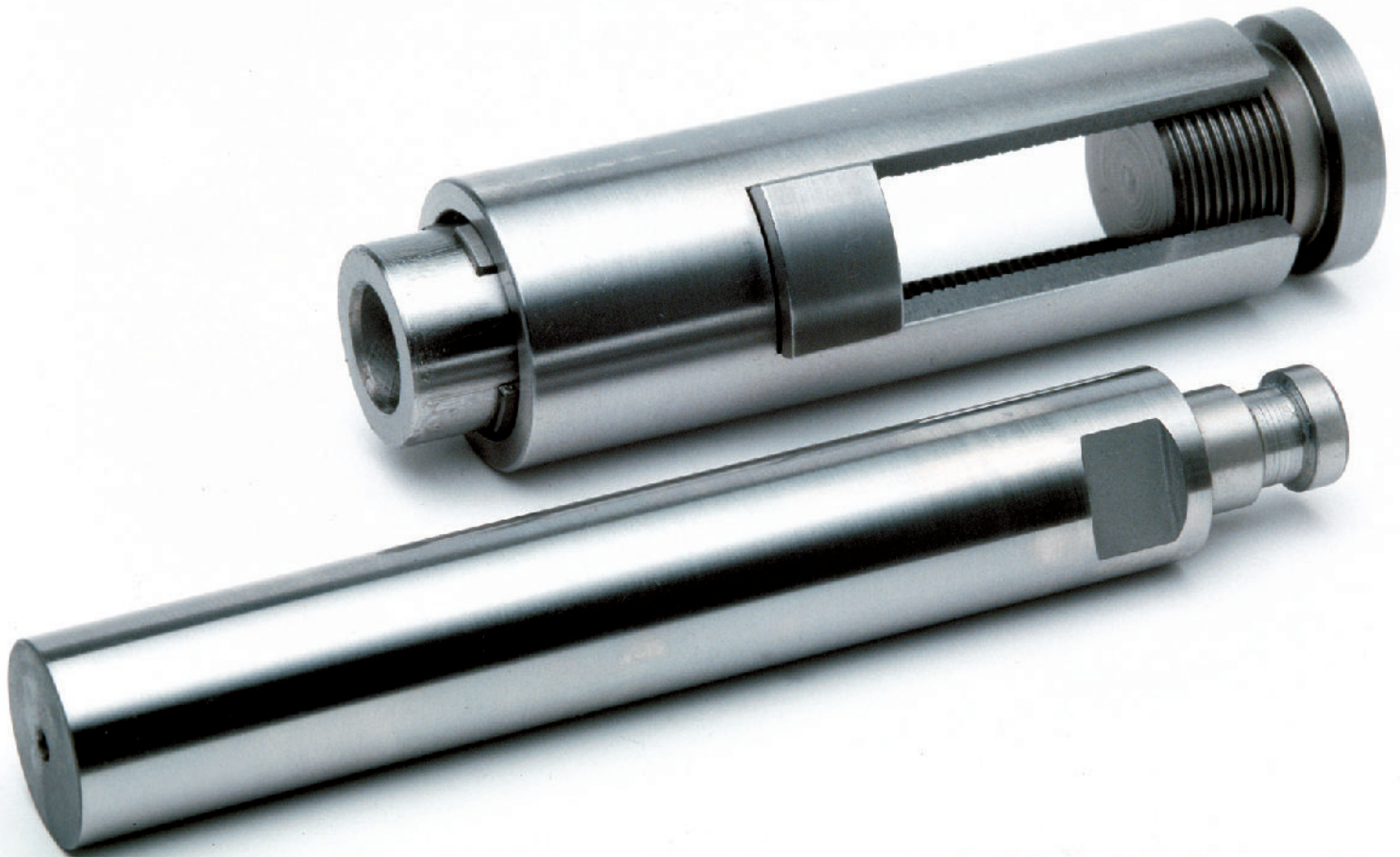

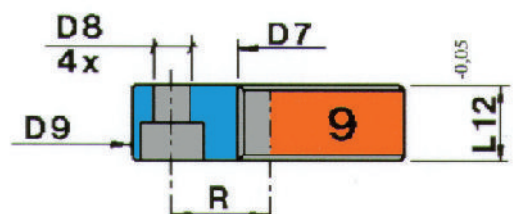

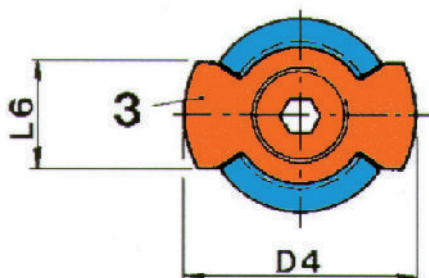
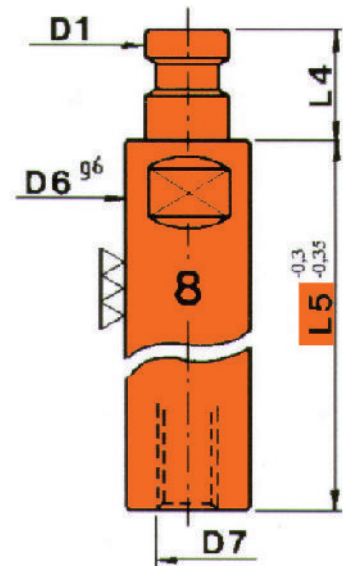
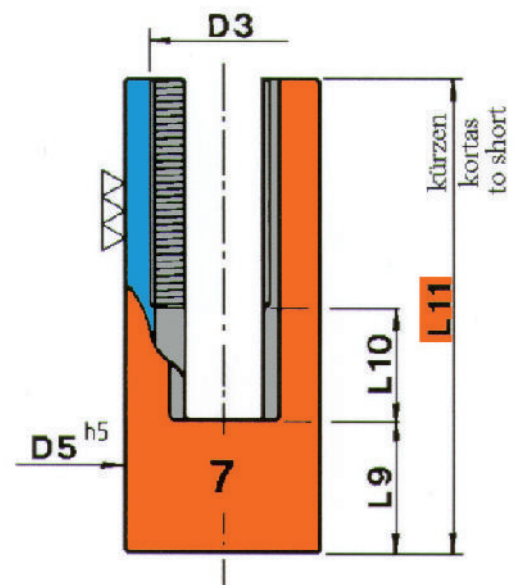
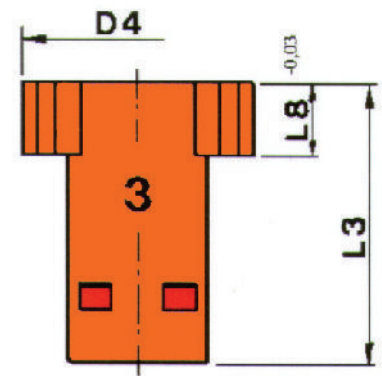
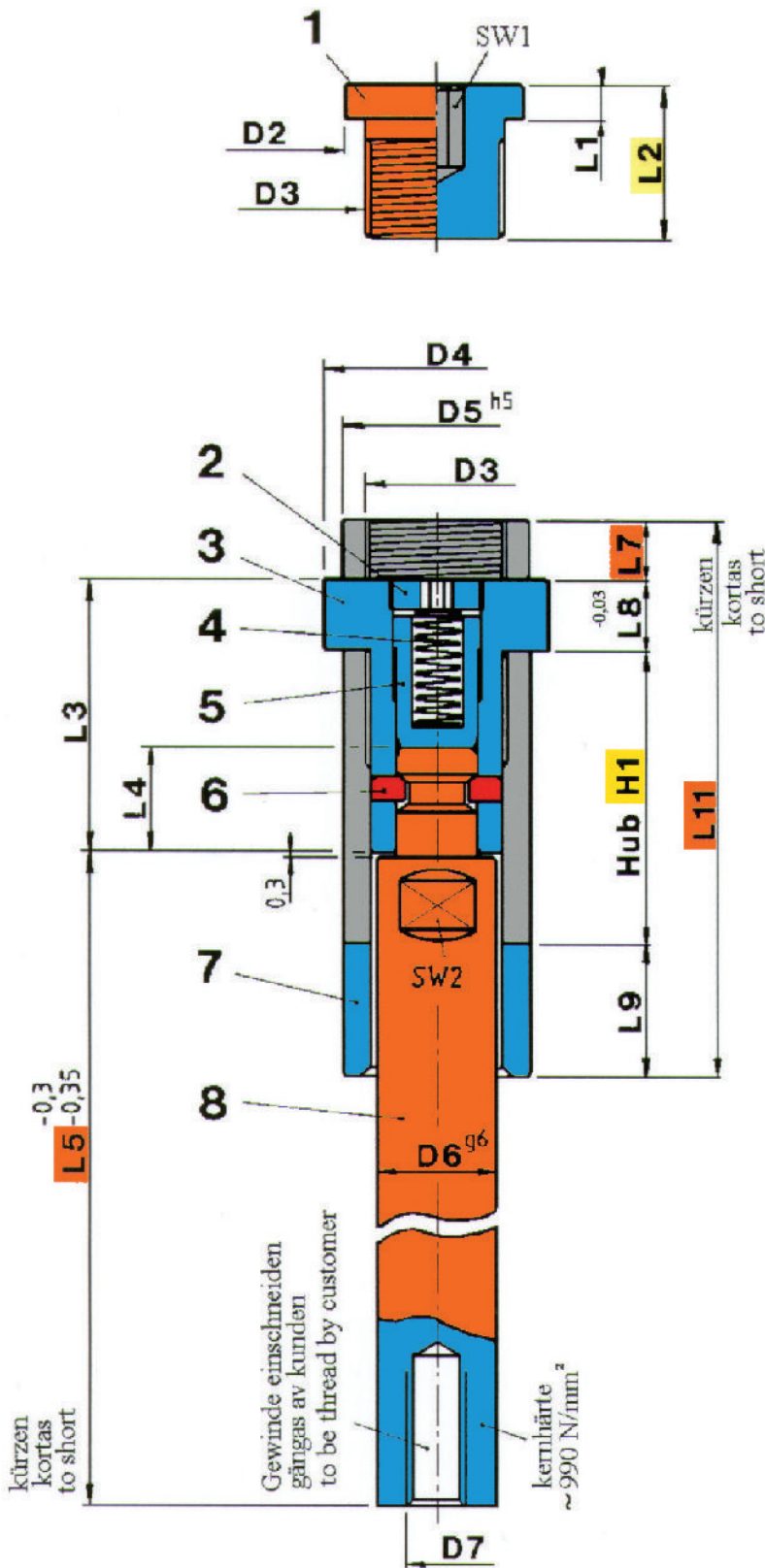
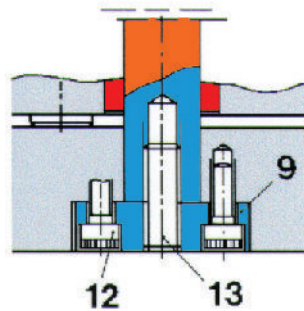
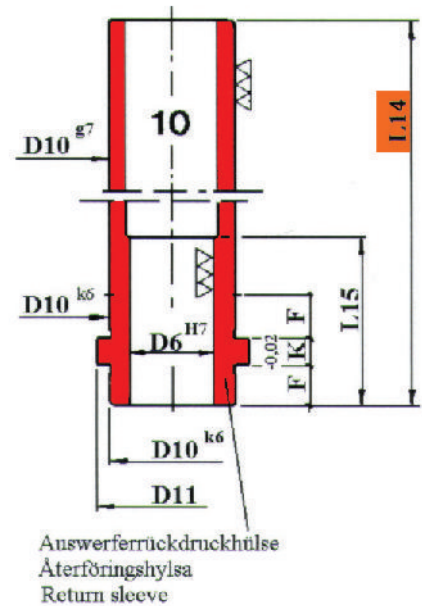
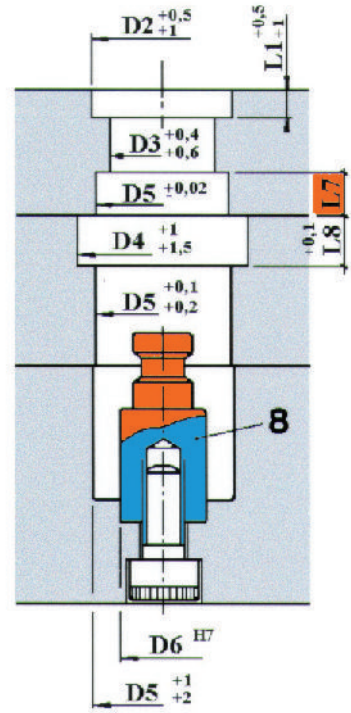
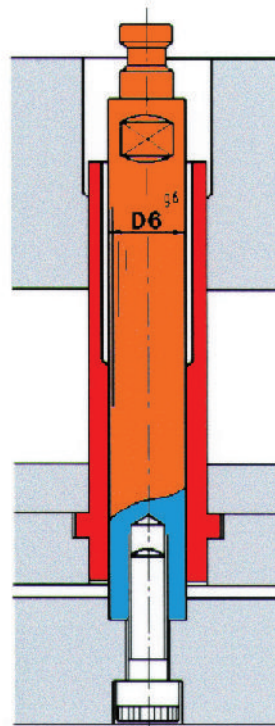
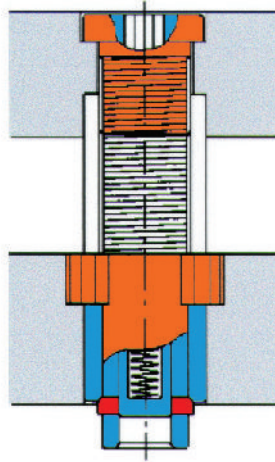
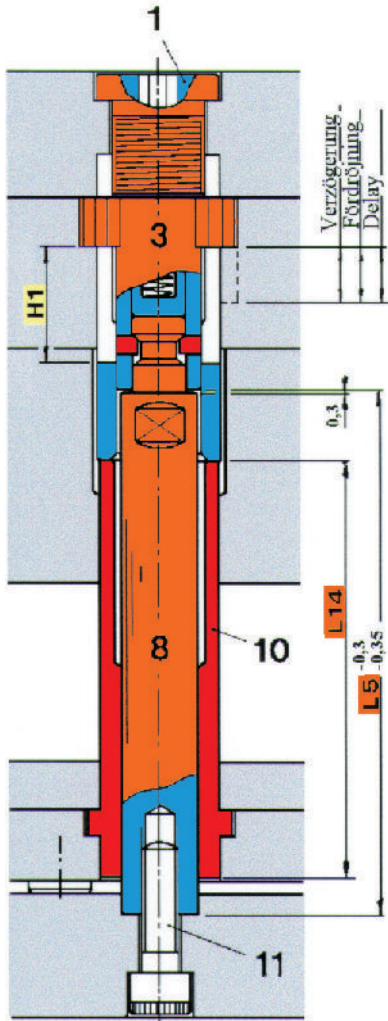

Spielfreier Einbau  
Spelfri inbyggnad  
Clearance-free installation

- Shortened parts can be delivered
- Fertig gekürzte Teile sind erhältlich
- Avkortade delar kan erhållas

- State at order
- Bestellungen-Angaben
- Anges vid beställning

Typ	D1	D2	D3	D4	D5	D6	D7	D8	D9	D10	D11	L1	L2	L3	L4	L5	L6			
EK-28	11,5	28	M21x1,5	34	28	18	M8	5,4	38	27	34	6	8	26	35	45	18	110	220	16
EK-34	14	32	M25x1,5	41	34	22	M10	6,5	45	32	39	6	8	26	35	56	20	130	260	20
EK-46	18	40	M32x1,5	54	46	30	M12	6,5	54	42	50	10	12	45	55	74	25	160	320	26

Typ	L7	L8	L9	L10	L11	L12	L14	L15	R	F	K	H1	SW1	SW2	kN				
EK-28	12	12	22	14	40	76	102	10	110	160	38	13,5	11	6	5-30	30-56	10	14	20
EK-34	12	14	30	18	54	98	134	12	130	190	48	16	11	6	6-42	42-78	12	17	30
EK-46	16	18	40	25	73	132	180	14	170	250	62	20	19	8	10-58	58-106	14	24	70

Size	EK- _____
Stroke	H1 _____
Length	L2 _____
"	L5 _____
"	L7 _____
"	L11 _____
"	L14 _____

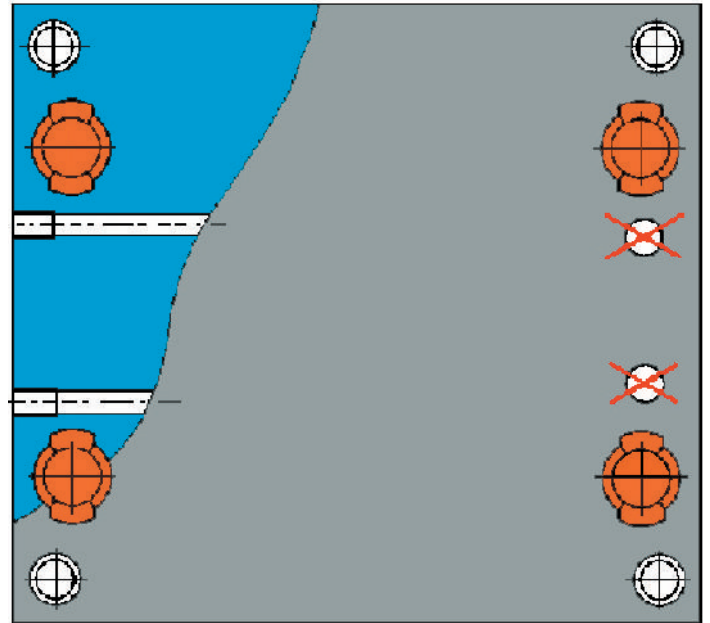
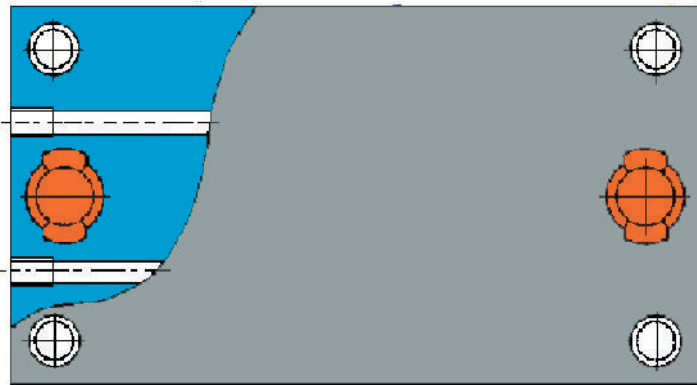

### Installation

1. Determine stroke H1 and shorten parts 7 and 8.
2. Length L5 must be made 0,3mm (-0,05) shorter than the installation dimensions.
3. On the length L7, D5 must be made to a tolerance of (+/-0,02).
4. Adapt length L14 to return sleeve 10

### Note!

For fast opening moulds and heavy plates will extra stroke limitation be necessary. The return sleeve 10 must be ordered separately.



### Einbau

1. Hub 1 bestimmen und Teil 7 und 8 ablängen.
2. Länge L5 0,3 mm (-0,05) kürzer als die Einbauhöhe ausführen.
3. D5 (+/-0,02) auf Länge L7 genau einarbeiten.
4. L14 ausmessen und Länge für Rückdruckhülse 10 anpassen.

### Achtung!

Zusätzliche Hubbegrenzung für schnelle Öffnungsbewegungen und schwere Platten einführen. Auswerferrückdruckhülse 10 muß separat bestellt werden.



### Inbyggnad

1. Bestäm slaglängd H1 och korta av del 7 och 8.
2. Längd L5 måste utföras 0,3mm (-0,05) kortare än inbyggnadsmåttet.
3. På längd L7 skall D5 göras på tolerans (+/-0,02).
4. Anpassa längden L14 på återföringshylsa 10.

### OBS!

För tunga plattor och snabbt öppnande verktyg införes extra slagbegränsning. Återföringshylsa 10 måste beställas separat.