

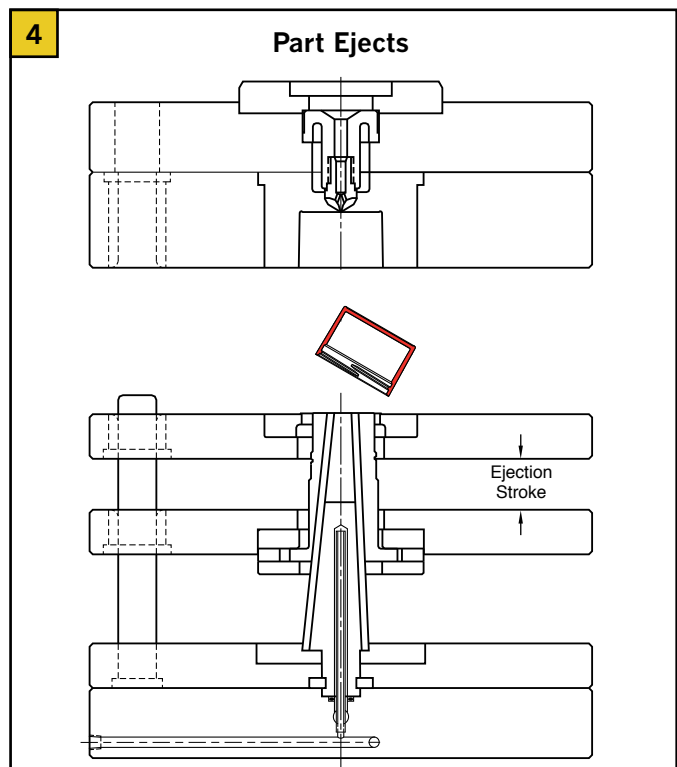

The DT Series Collapsible Cores offer a more compact design and simplified mold approach over other tool designs.

Available in four standard sizes and also as customs, DT Series Collapsible Cores eliminate the need for complex unscrewing mechanisms as well as providing solutions for unmoldable internal undercut features such as o-ring grooves, slots, and snap fit details.

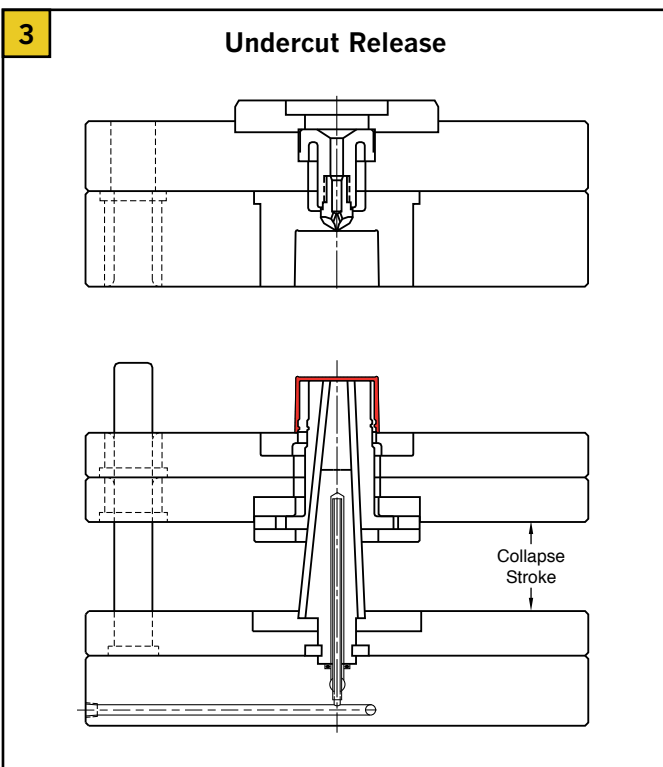
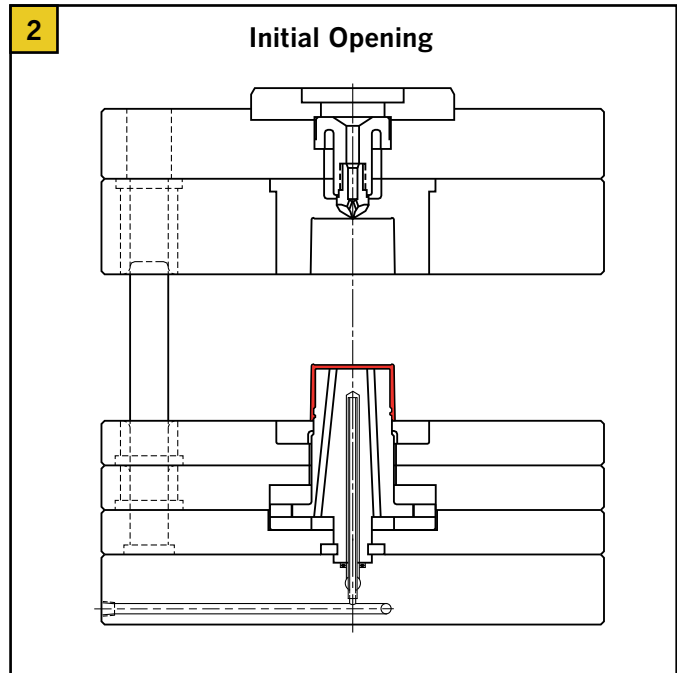
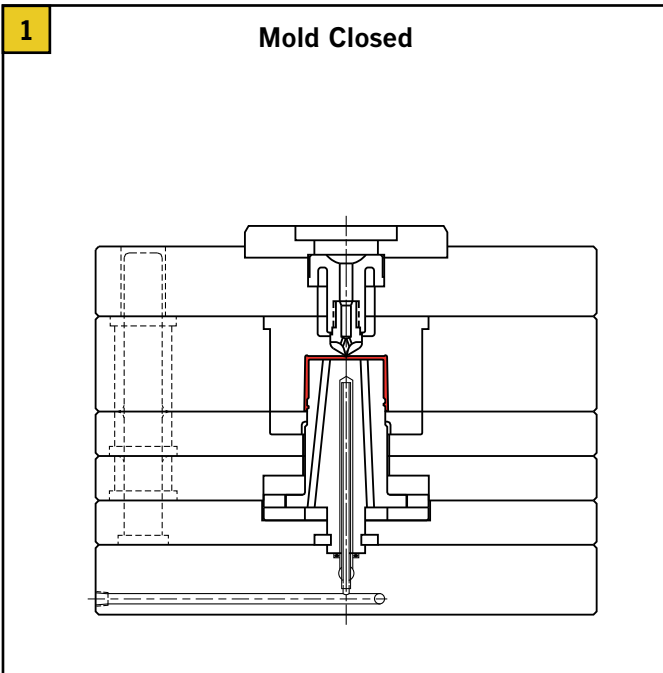

US Patent No. 8,033,810
Other patents pending

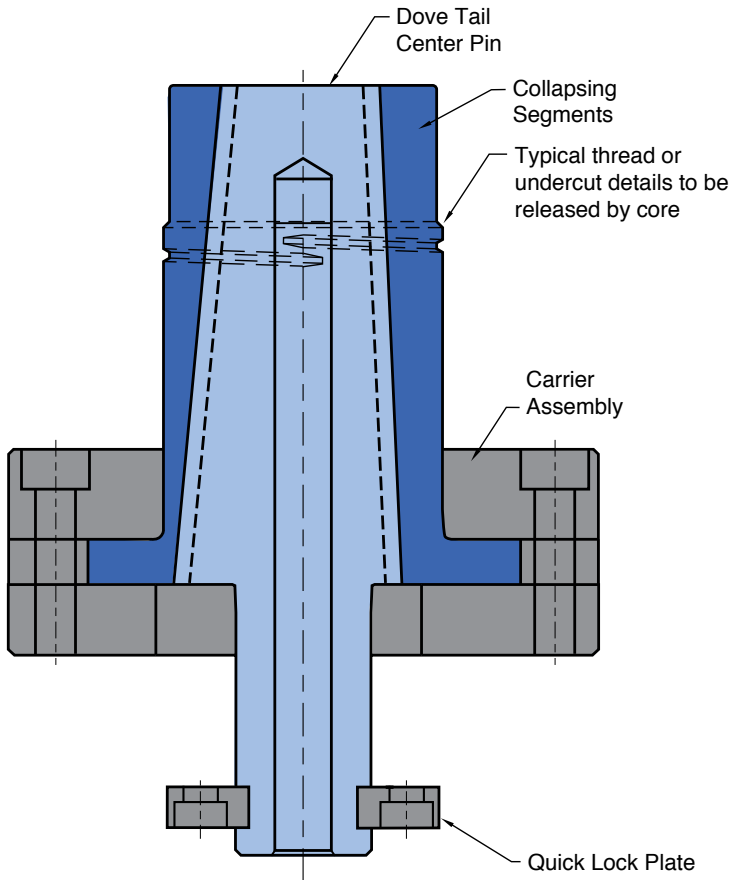

Collapsing Segments

M A-2 **H** 54-57 HRC

- Designed to mechanically collapse when the center pin is withdrawn.
- The fit between the segments is controlled to permit flash-free molding.

Center Pin

M D-2 **H** 58-63 HRC

- Serves to expand the segments of the core to their molding position
- The pin may be flush to the core face.

Carrier Assembly

M D-2 **H** 58-62 HRC

- Mounts DT Core assembly to the mold carrier plate.
- Provides guided and anti-rotational segment movement.



Quick Lock Feature

Plate Material: A-2, 54-57 HRC

Utilizing Progressive's exclusive Quick Lock mounting configuration, the DT Core can be removed and serviced while the mold remains in the press. This feature allows for a higher cavitation percentage and lower maintenance costs than other tool design approaches.

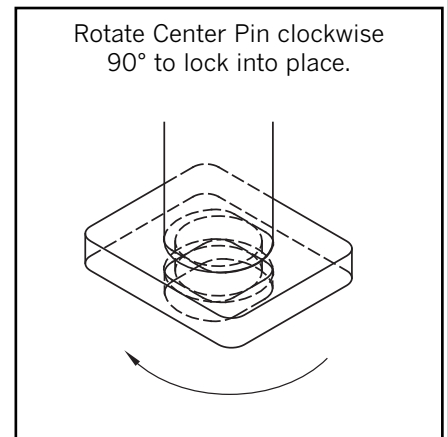
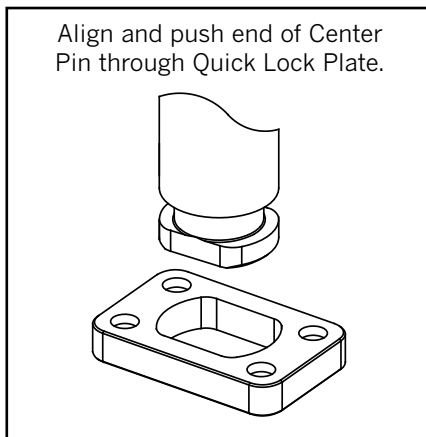
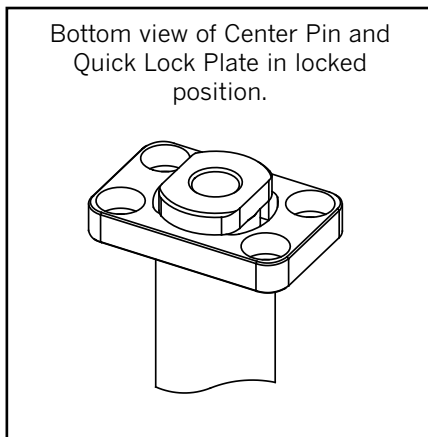

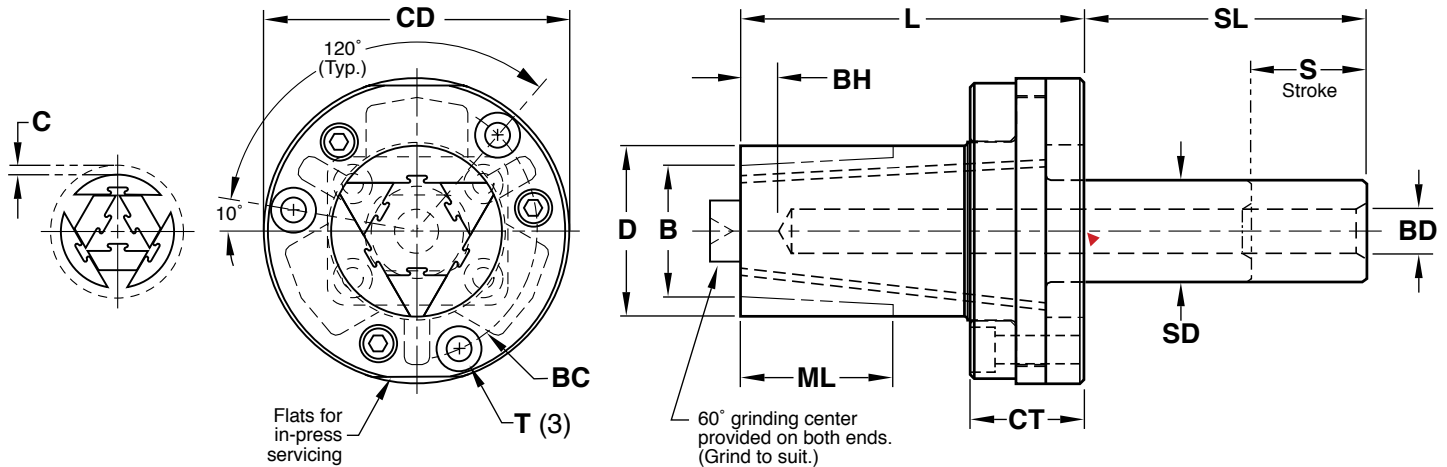

Note: All dimensions and tolerances are in millimeters.

► CAD insertion point

CATALOG NUMBER	D Maximum Outer Diameter	B Minimum Inner Diameter +3°/Side	ML Maximum Molding Length	C Maximum Collapse	CD Carrier Diameter +0.00 -0.05	CT Carrier Assembly Thickness ±0.05	L Core Length +0.1 -0.0	SL Shaft Length	SD Shaft Diameter +0.00 -0.02	BD Cooling Hole Diameter	BH Distance to Cooling Hole	BC Mounting Screw Bolt Circle	T Mounting Screws	S Maximum Collapse Stroke
DT18	21	17	22	1.1	53	21	60	60	16	6	6	40	M5 x 25	34
DT28	33	25	28	1.6	60	22	67	60	20	8	8	47	M5 x 25	38
DT38	42	33	43	2.1	76	28	85	60	25	10	10	60	M6 x 35	54
DT48	54	42	50	2.4	98	37	104	70	30	12	12	78	M8 x 40	62

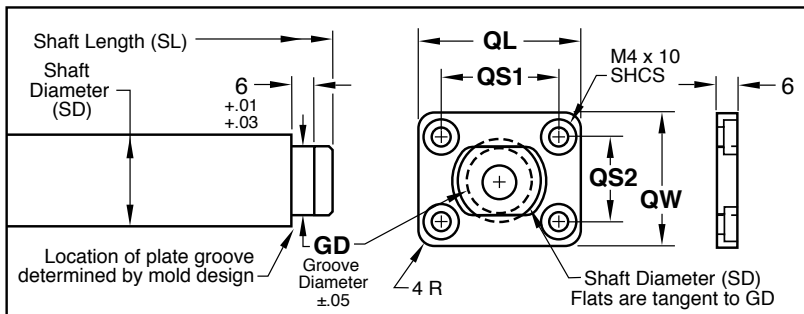

DOVE TAIL CATALOG NUMBER	GD	QL +0.00 -0.05	QW +0.00 -0.05	QS1	QS2
DT18	12	35	22	25	12
DT28	15	38	25	28	15
DT38	19	41	31	30	20
DT48	23	44	35	34	25

Each Dove Tail Collapsible Core includes:

- DT Series Core/Pin/Carrier Assembly
- Quick Lock Plate
- All mounting screws

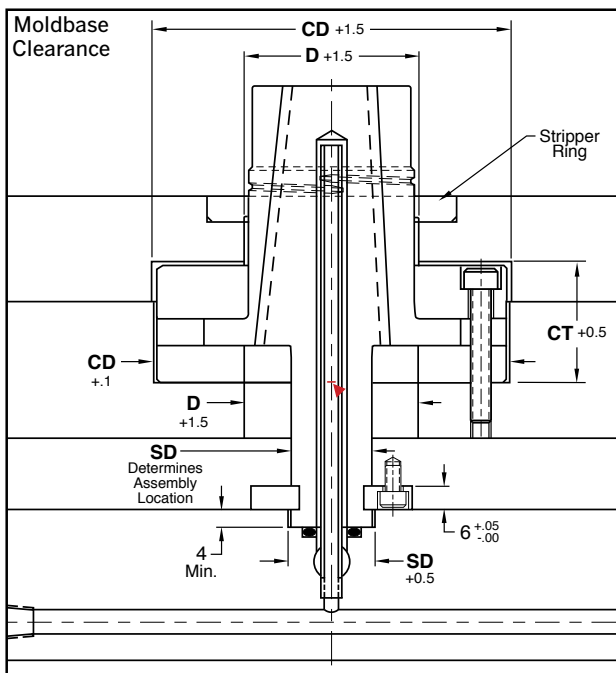

Application Guidelines

- All standard DT Series Cores offer 360° molding of threads or other undercuts.
- Molded parts do not need to be closed at one end. They may be partially or completely open.
- Stripper ring can be provided by moldmaker with either a tapered or straight fit, as shown in the machining guidelines at left.
- Parts with size requirements that fall outside of the standard sizes are available on a custom order basis.
- Progressive can provide Dove Tail cores with your thread or cap detail already machined. Also, coatings and treatments may also be provided. Email your part drawing or application to tech@procomps.com for a review.

Side Action

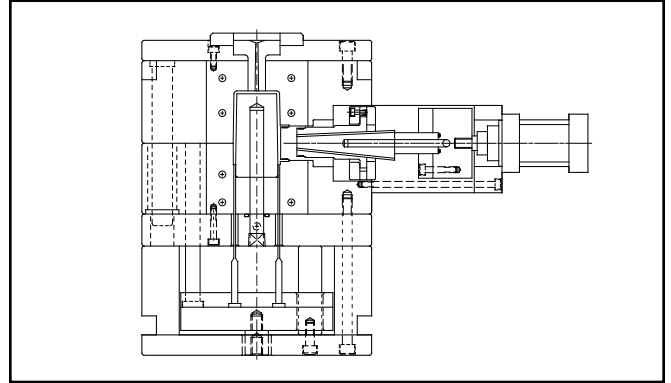
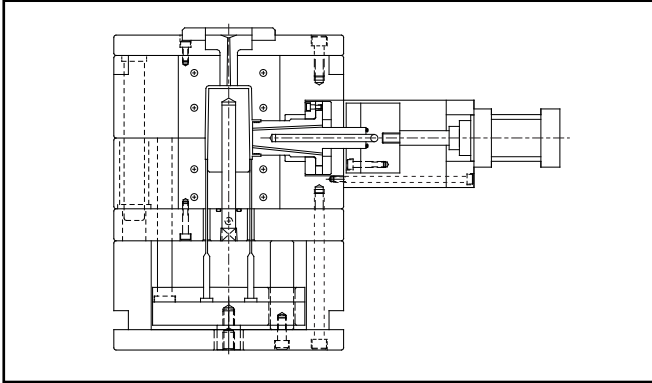

Cavity Side

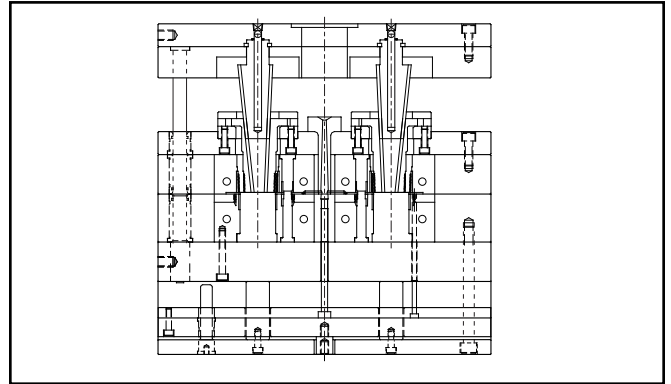
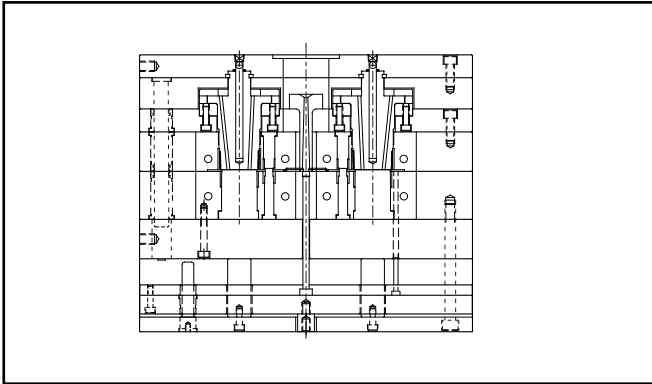

Boss Detail

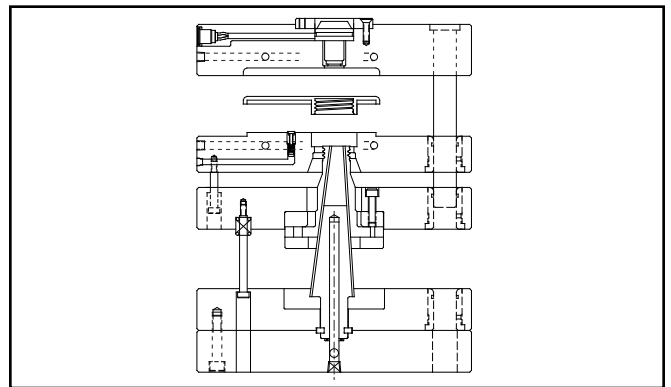
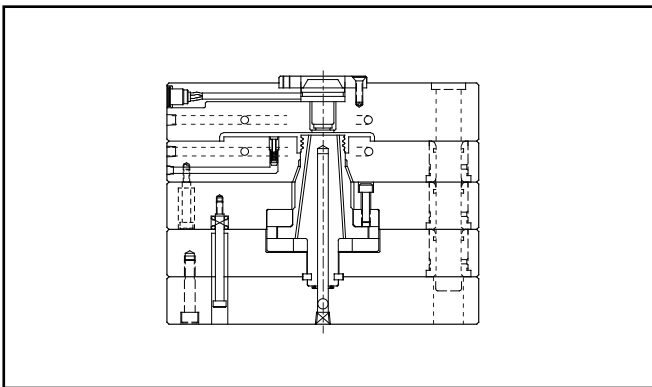

Seal Ring

